

EQUIPMENT DOOR IN FIRE WALLS

USED ONLY WHERE THE SUBSTATION IS BUILT INTO, OR IS ATTACHED TO THE STRUCTURE OF THE ASSOCIATED BUILDING

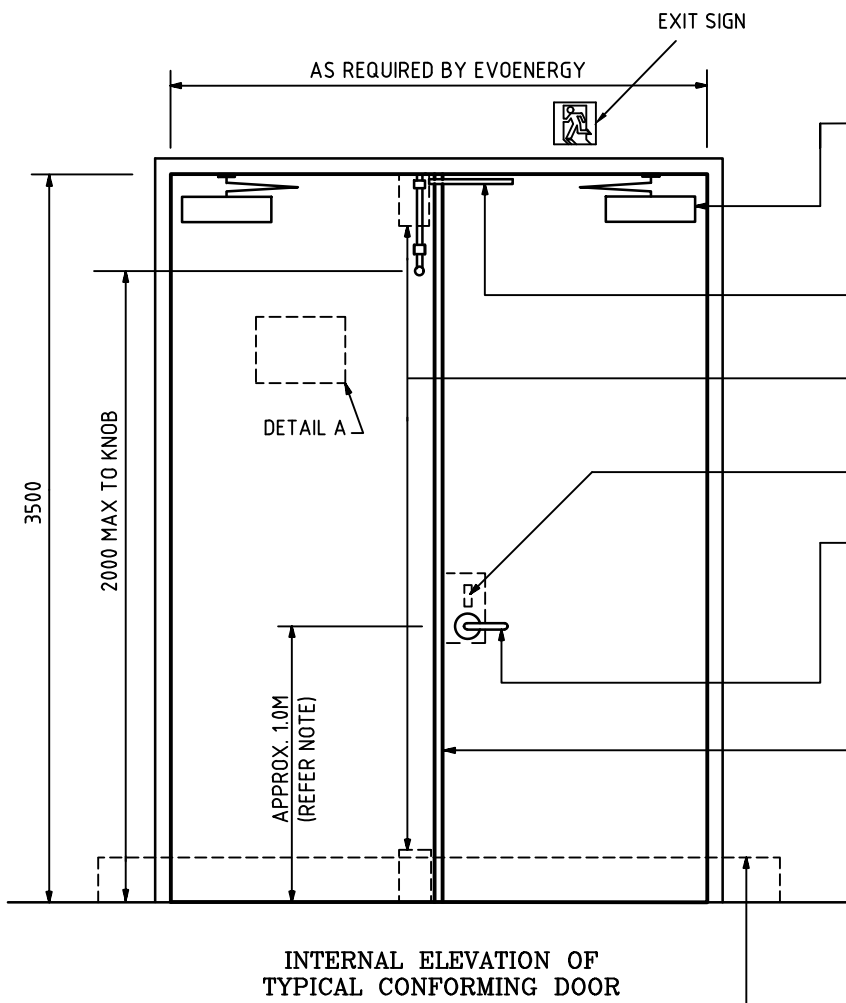

FIRE DOOR:-

ALL ELEMENTS MUST BE IDENTICAL TO ITEMS APPROVED ON FIRE TESTED DOORS. WATERPROOF FACES FOR EXTERNAL DOORS.

DOOR CLOSER:-

SURFACE MOUNTED PARALLEL ARM

DOOR SELECTOR UNIT:-

TO CLOSE THE DOOR LEAVES IN THE CORRECT SEQUENCE, FIXED LEAF FIRST

HINGES:-

STEEL, GALV STEEL OR STAINLESS STEEL. NUMBER VARIES WITH DOOR SIZE

FIXED LEAF BOLTS:-

LATCHING BOLTS TO SECURE FIXED LEAF TOP LATCHES OR AUTOMATIC FLUSH BOLTS

KEY CYLINDER:- (WHERE REQUIRED)

EVOENERGY EXCLUSIVE PROFILE

DOOR LOCK & FURNITURE

LEVER HANDLES IN MORTISE LOCK BETWEEN 900 & 1200 ABOVE FFL
STOREROOM OR ESCAPE LOCK FUNCTIONS WITH AUTO-DEADLOCK FUNCTION
D PULL HANDLE 16dia x 100mm ON OUTSIDE SECURED TO FRAME WITH AMPLE FINGER GRIP

MEETING STILES:-

ALUMINIUM T'BAR ASTRAGAL

DOOR OPERATION:-

THE DOORS MUST CLOSE IN THE CORRECT SEQUENCE, LATCH INTO THE STRIKE AND LOCK WITH EACH DOOR OPERATION. FREE LEVER HANDLE INSIDE FOR ESCAPE WITHOUT A KEY AT ALL TIMES.

THRESHOLD & BUND:-

INCOMBUSTABLE THRESHOLD OR SILL WITH 100 x 100 min. MASONRY BUND

BCA REQUIREMENTS

FIRE DOOR FRL	(2hr) TO COMPLY WITH AS1905.1	C2.13(a)
FIRE DOOR SIGNS	"FIRE SAFETY DOOR DO NOT OBSTRUCT DO NOT KEEP OPEN"	D2.23(b)
ESCAPE HARDWARE		D2.21
DOOR HEIGHT	LEVER HANDLE BETWEEN 900 & 1200 ABOVE FFL	D1.6(a)
DOOR WIDTH	MINIMUM CLEAR UNOBSTRUCTED HEIGHT 1980mm.	D1.6(f)
	MINIMUM CLEAR UNOBSTRUCTED WIDTH 750mm.	

AUSTRALIAN STANDARDS

SAFETY SIGNS	"DANGER HIGH-VOLTAGE-KEEP OUT" WITH SYMBOL 350W X 175H - ENA DOC 015	AS1319
FIRE DOOR	LATCHING HARDWARE ONLY. NO HOLD OPEN BOLTS.	AS1905
EXIT SIGN	EXIT SIGNS SHALL COMPLY WITH THE REQUIREMENTS OF AS2293.3	AS2293.3

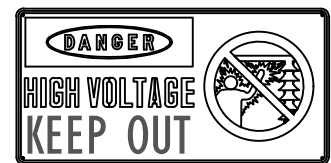

DETAIL 'A'
SAFETY SIGN

EVOENERGY REQUIREMENTS

DIRECTION OF SWING	TO SWING IN THE DIRECTION OF ESCAPE (PUSH OUTWARDS)
ELECTRIC DOOR RELEASE	NOT PERMITTED
BUND	100 x 100 MINIMUM MASONRY BUND SILICON SEAL TO SILL & WALL
UNLOADING APRON	STRAIGHT FLAT APPROACH FOR CRANE FROM ROAD OR DRIVEWAY. APPROX. 3.6M W.x 3.6M H.

FRL = FIRE RESISTANCE LEVEL

D	LOGO AND REFERENCES UPDATED	18/03/2018	B. Suthar	W. Ibrahim
C	UPDATED AS PART OF CHAMBER SUBSTATION STANDARDS REVIEW	29/11/2017	C. Desai	W. Ibrahim
B	EXIT SIGN NOTE AMENDED	23/01/2013	BS	WC
A	EXIT SIGN AND ACTEWAGL LOGO ADDED, DANGER SIGN CHANGED	15/02/2008	AC	GA
No	Revision	Date	Checked	Approved

The information contained within this drawing & associated electronic file shall remain the property of Evoenergy and shall not be copied or used for any other purpose without express written permission from Evoenergy. © Evoenergy. 2018.

ACT Cadastral information supplied by the ACT Environment & Sustainable Development Directorate. © ACT Gov. 2018.

evoenergy

EQUIPMENT DOOR IN FIRE RATED WALLS FOR INDOOR CHAMBER SUBSTATION

Drawn:	Date:
Designed: A-NNR	
Checked:	
Approved: FRASER	

Project No:	Status: Current
Work Pack No:	File:

A4	4951-25	REV D
-----------	----------------	-----------------